

Matt Wiese - Leadership Project, Troop 117, Dublin OH

Nest Box Parts: Each nest box is composed of **6 pieces** - Top (Roof), Front, Left Side, Right Side, Back and Bottom (Floor). Collect these together before beginning assembly.

You will need **14** of the 1 1/2" screws and **2** small screws for the sparrow trap door.

Numbers = sequence of assembly. Detailed instructions on following pages.

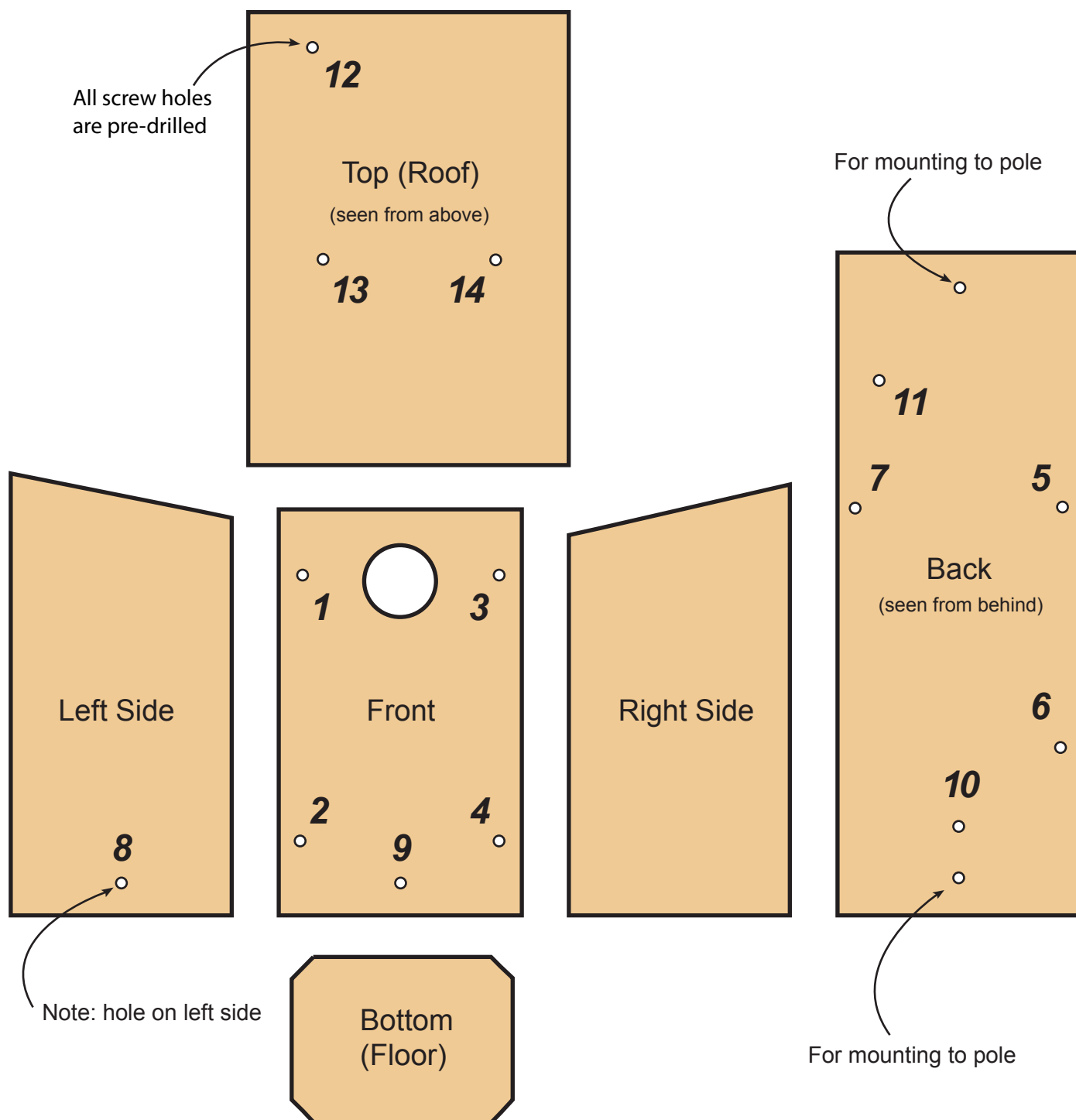

Matt Wiese - Leadership Project, Troop 117, Dublin OH

Nest Box Assembly: ON THE INSIDE of the nestbox measure $1\frac{3}{8}"$ and $3\frac{3}{4}"$

in a centerline from the bottom edge of the round opening. Mark both measurements.

At those measurements insert the 2 small screws provided. Do not screw in all the way.

These will act as anchors for the Sparrow Trap.

Step 1

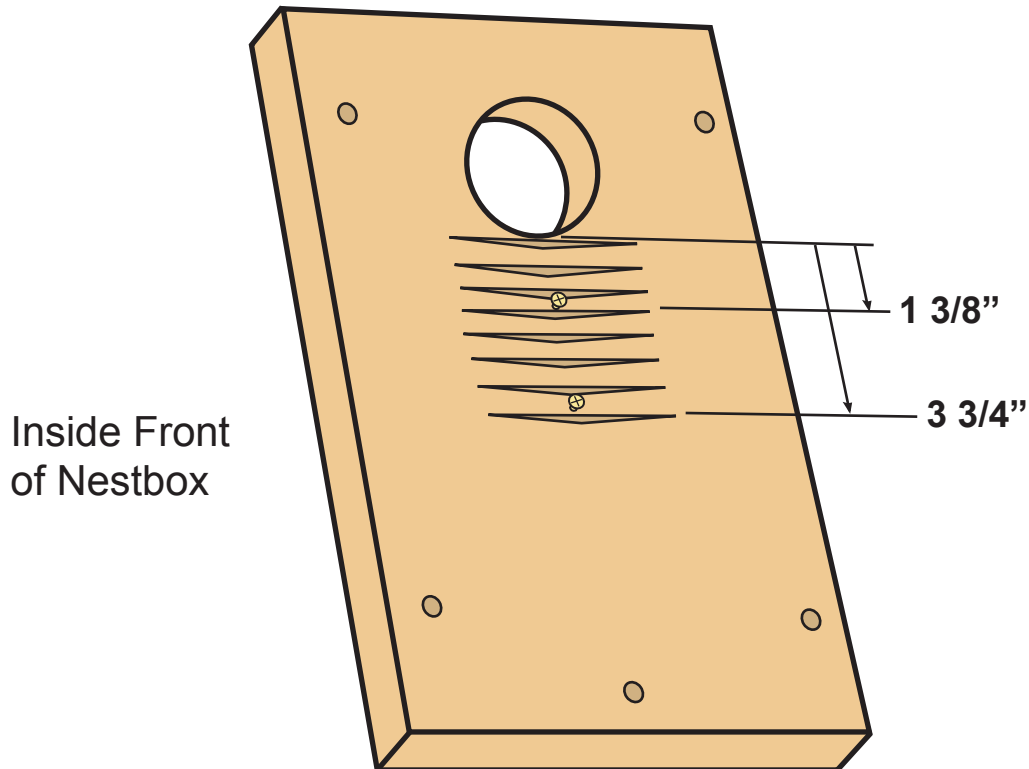

Matt Wiese - Leadership Project, Troop 117, Dublin OH

Nest Box Assembly: Using the screws provided attach the **Front** to the **Left Side** and then to the **Right Side**. Follow the numbering sequence shown below.

Step 2

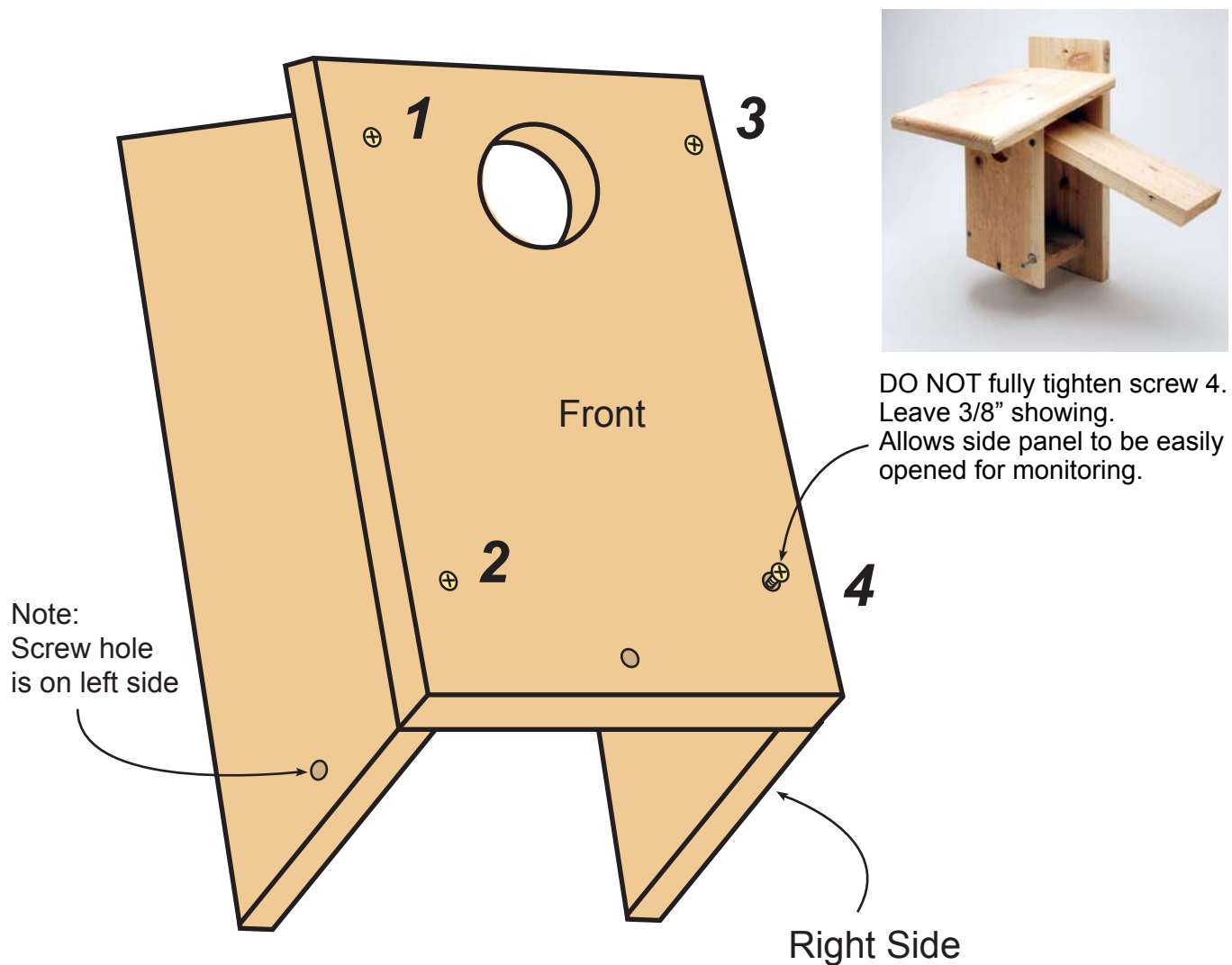

Matt Wiese - Leadership Project, Troop 117, Dublin OH

Nest Box Assembly: Position **Back** piece to the **Front** and **Sides** on the pencil line.

(Important: pencil line faces forward.)

Fasten screws into the **Back** in the sequence shown in the diagram below.

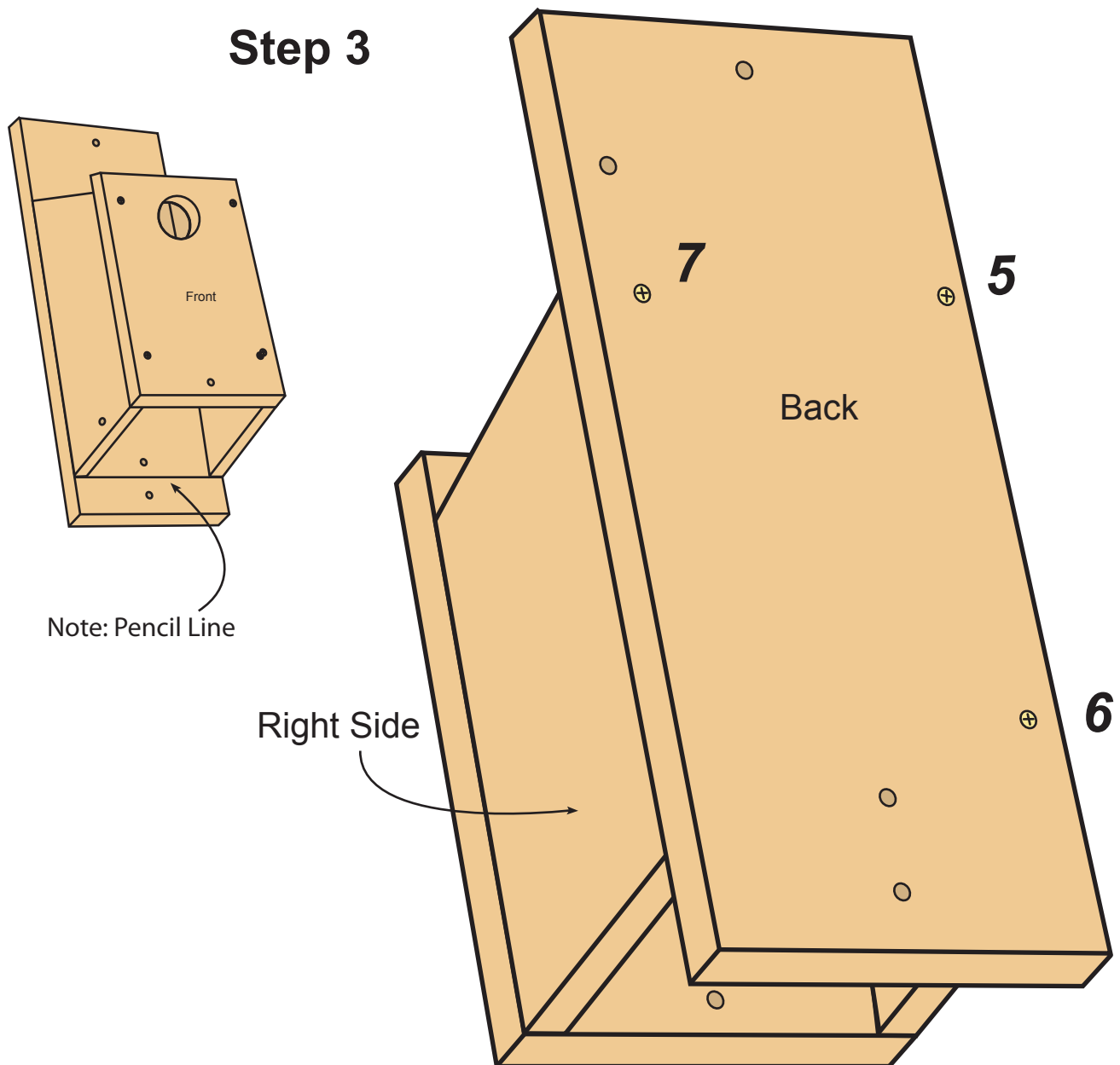

Matt Wiese - Leadership Project, Troop 117, Dublin OH

Nest Box Assembly: Inset **Bottom (Floor)** piece. Note: recessed 1/8".

Fasten screws in sequence shown below.

Step 4

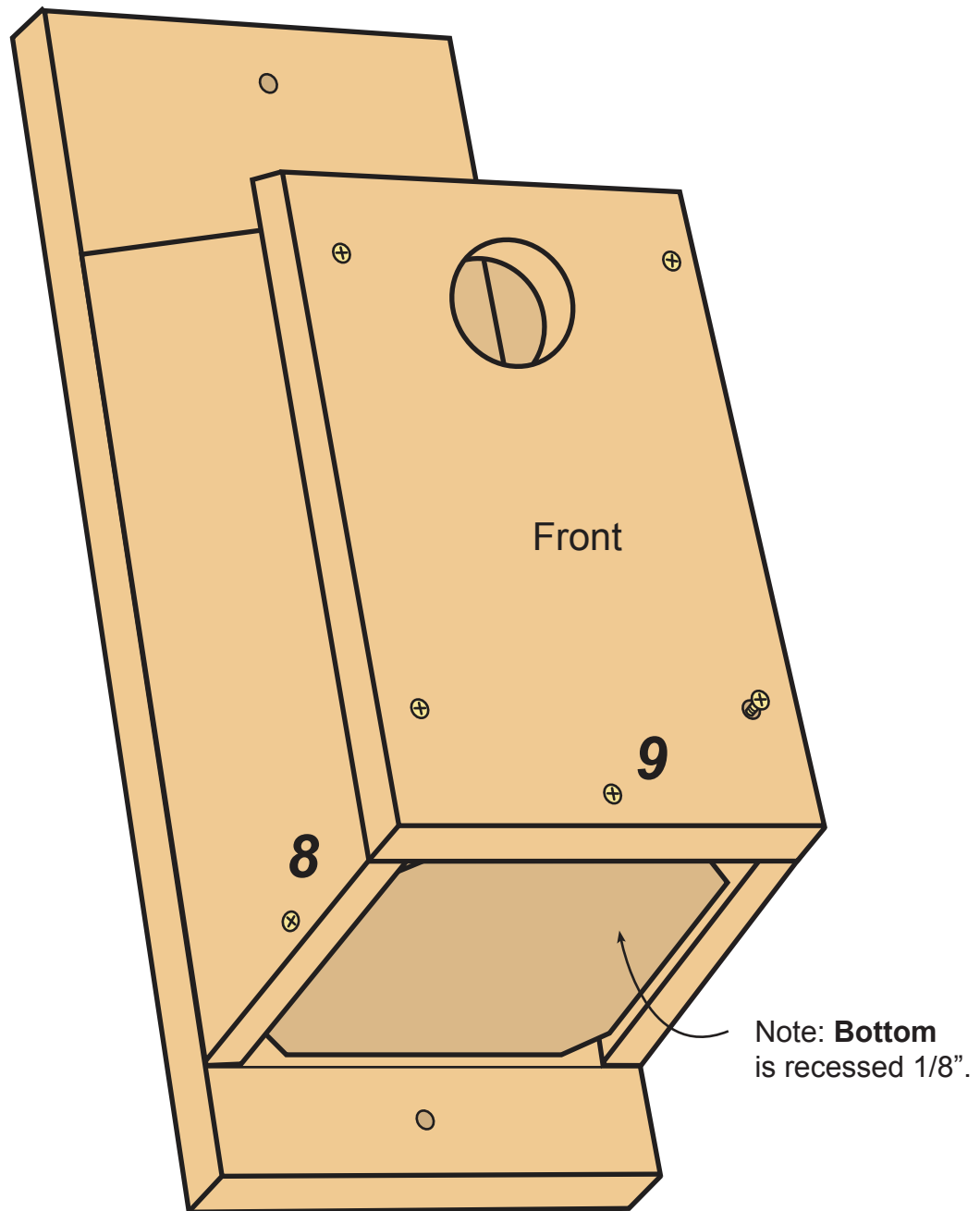

Matt Wiese - Leadership Project, Troop 117, Dublin OH

Nest Box Assembly: Secure **Bottom (Floor)**. Center align **Top (Roof)** to the **Back** and fasten in place. Follow sequence indicated below.

Step 5

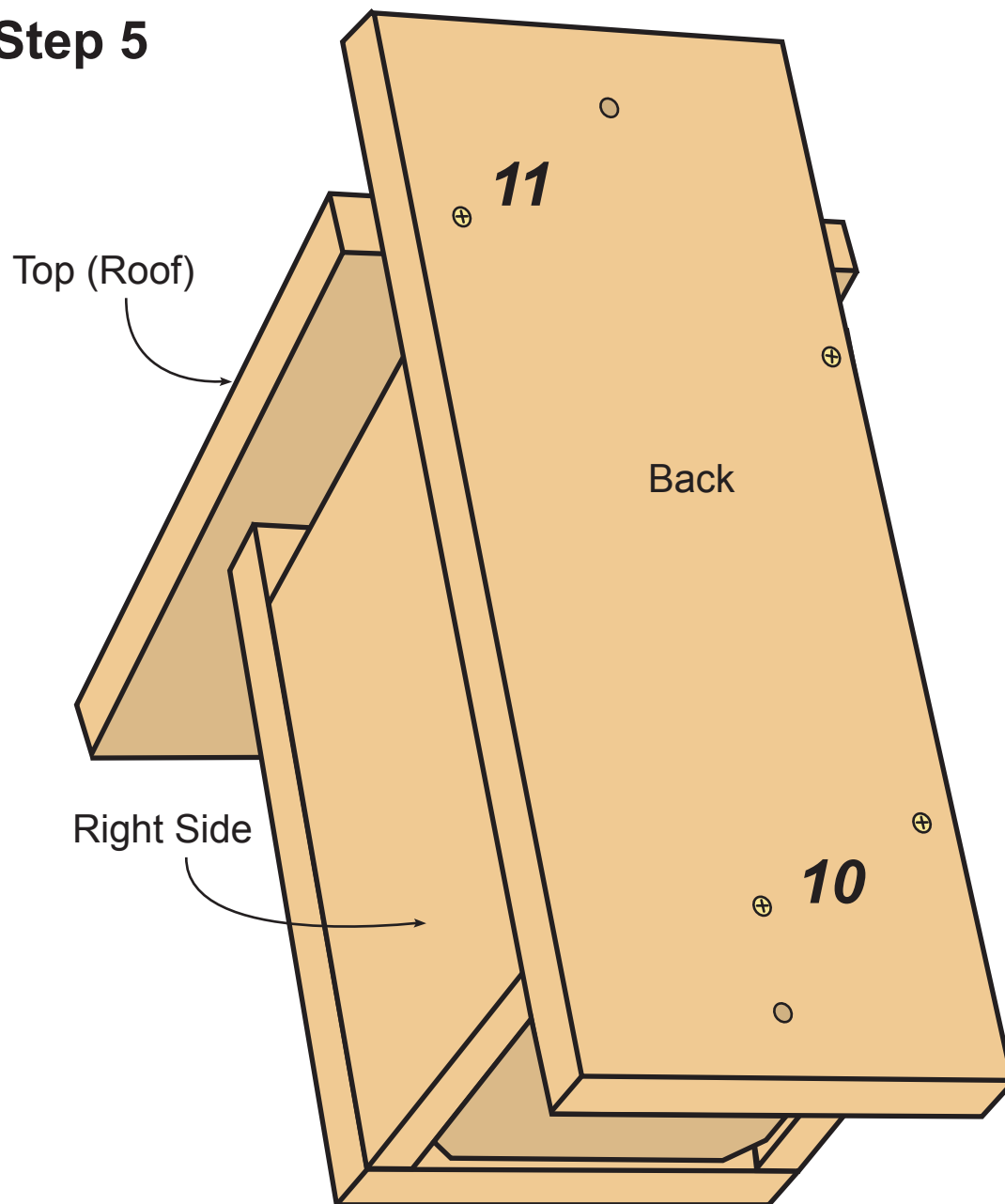

Matt Wiese - Leadership Project, Troop 117, Dublin OH

Nest Box Assembly: Secure **Top (Roof)** to nestbox. Follow fastening sequence indicated below. Assembly is complete.

Step 6

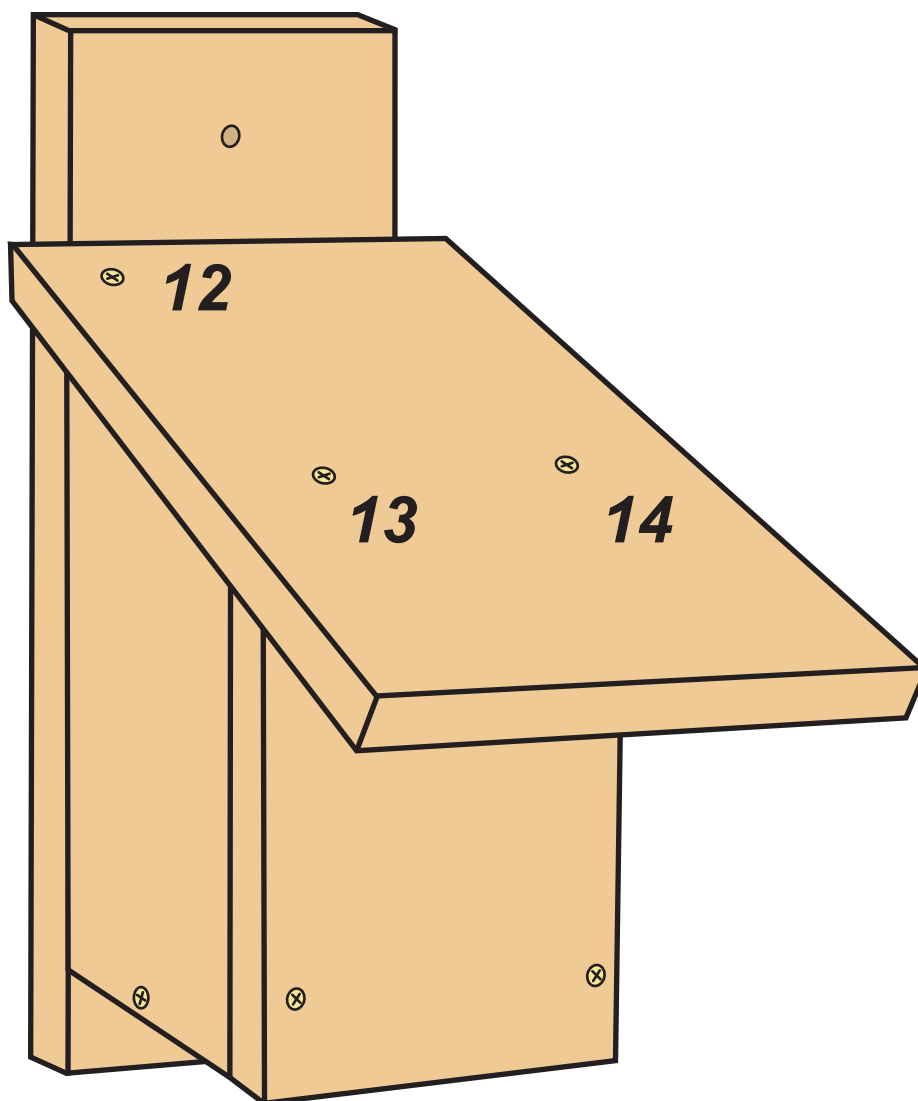

Matt Wiese - Leadership Project, Troop 117, Dublin OH

Nest Box Installation on location:

- 1) Pound 1" EMT conduit pipe 2 - 2.5 ft into the ground.
Point small hole in pipe in southeast direction.

- 2) Secure hose clamp to pipe
16.75" from the top

- 3) Slide pre-assembled and painted
baffle onto pipe.
(designed to hang loosely)

- 4) Secure nest box to top
of pipe with stainless
steel bolt. Ensure that nestbox
opening is pointed southeast.

- 5) Secure bottom of nest box to
pipe with Zip tie.

- 6) Mark coordinates using GPS.

